



SAN DIEGO STATE
UNIVERSITY

Georgia

S

SCIENCE

T

TECHNOLOGY

E

ENGINEERING

M

MATH

Status Meeting

SDSU-Georgia





SAN DIEGO STATE
UNIVERSITY

Georgia

S

SCIENCE

T

TECHNOLOGY

E

ENGINEERING

M

MATH

Components

Degree Delivery

Capacity Building

Enrollment and Recruiting



SAN DIEGO STATE
UNIVERSITY

Georgia

S

SCIENCE

T

TECHNOLOGY

E

ENGINEERING

M

MATH

Degree Delivery





SAN DIEGO STATE UNIVERSITY

Georgia



Spring 2016

Feb 29

Apr 11

Jun 10

Jun13-23

MATH 151

PHYS 195 (Online lecture)

LING 94

LING 100

LING 200

ORAL COMM 103

MATH 150

CON E 101

Final

CHEM 201

Apr8-13

PHYS 195 Lab

Final Exams



SAN DIEGO STATE UNIVERSITY

Georgia

S
SCIENCE

T
TECHNOLOGY

E
ENGINEERING

M
MATH

Fall 2015

Sep 28

Nov 5

Dec 7

Dec 8-16

ECON 102

LING 94

LING 100

BIO 100 Online

MATH 141

Final Exams

MATH 150

CHEM 100

CHEM 200

Nov 2-4

Final Exams



SAN DIEGO STATE
UNIVERSITY

Georgia

S

SCIENCE

T

TECHNOLOGY

E

ENGINEERING

M

MATH

SDSU-G Grade summary - Fall 2015

OVERALL SDSU-G GPA 3.35

Course&number of students	Units	A	A-	B+	B	B-	C+	C	C-	D+	D	D-	F	Course GPA
GPA Weight		4	3.7	3.3	3	2.7	2.3	2	1.7	1.3	1	0.7	0	
Econ 102 - 64	3	22	13	8	6	7	1	2	0	2	0	3	0	3.29
Ling 100 - 16	3	2	4	6	3	1	0	0	0	0	0	0	0	3.39
Chem 100 - 18	4	4	2	2	1	6	1	1	0	0	0	0	1	2.97
Chem 200 - 16	5	3	3	4	2	3	1	0	0	0	0	0	0	3.29
Math 141 - 46	3	17	9	6	3	11	0	0	0	0	0	0	0	3.47
Math 150 - 64	4	30	12	3	3	4	4	3	5	0	0	0	0	3.40
Bio 100 - 15	3	8	2	1	1	0	0	2	1	0	0	0	0	3.43
Ling 94 - 65**	3	3	10	15	4	6	2	3	2	0	0	0	20	2.16
Overall Totals		86	45	30	19	32	7	8	6	2	0	3	1	3.35

** Grades were reported as noted to GEO Partners, but these are Cr/NC courses at SDSU that do not figure in GPA calc. This value is noted for reference but is NOT in the Overall SDSU-G GPA calculation



SAN DIEGO STATE
UNIVERSITY

Georgia

S

SCIENCE

T

TECHNOLOGY

E

ENGINEERING

M

MATH

Histogram of Fall 2015 GPA's of SDSU-G students

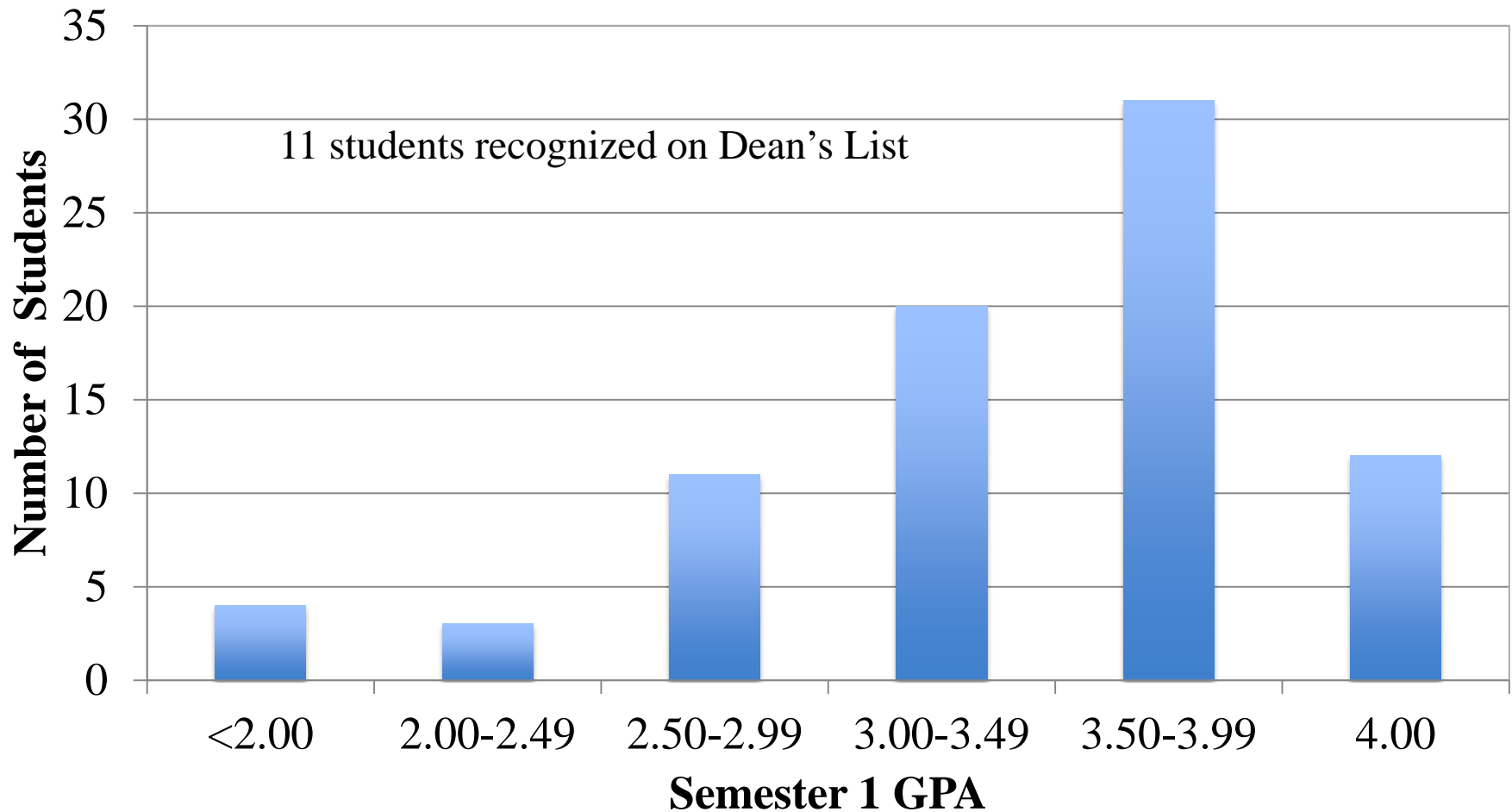



SAN DIEGO STATE
UNIVERSITY

Georgia

S

SCIENCE

T

TECHNOLOGY

E

ENGINEERING

M

MATH

Relative Frequency Histograms of Fall 2015 GPA's of SDSU-G students
by Gender

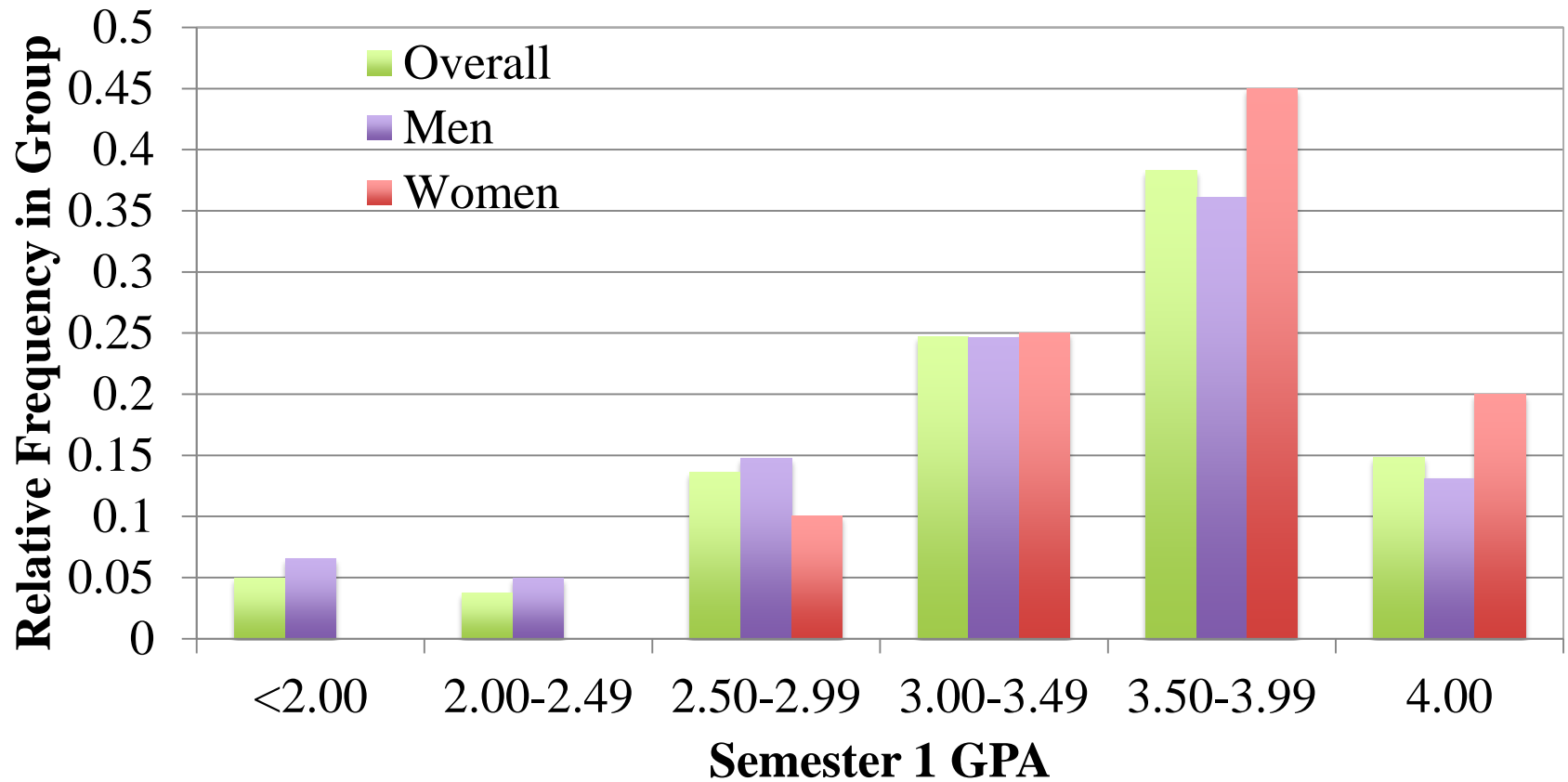



SAN DIEGO STATE
UNIVERSITY

Georgia

S

SCIENCE

T

TECHNOLOGY

E

ENGINEERING

M

MATH

Relative Frequency Histograms of Fall 2015 GPA's of SDSU-G students
by Social Vulnerability (S/V) status

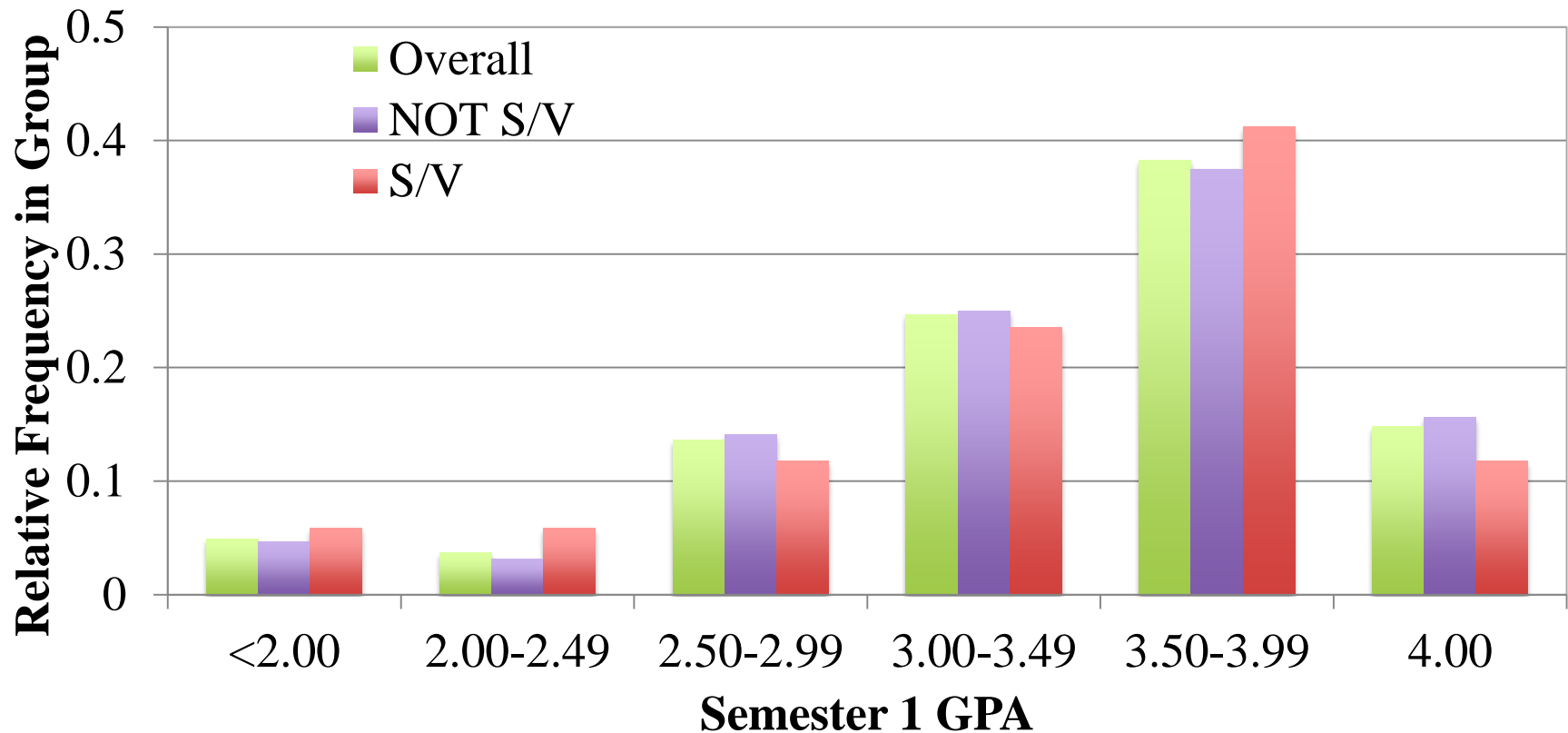



SAN DIEGO STATE UNIVERSITY

Georgia



NAEC results for LING 94 students, NC group compared to CR group

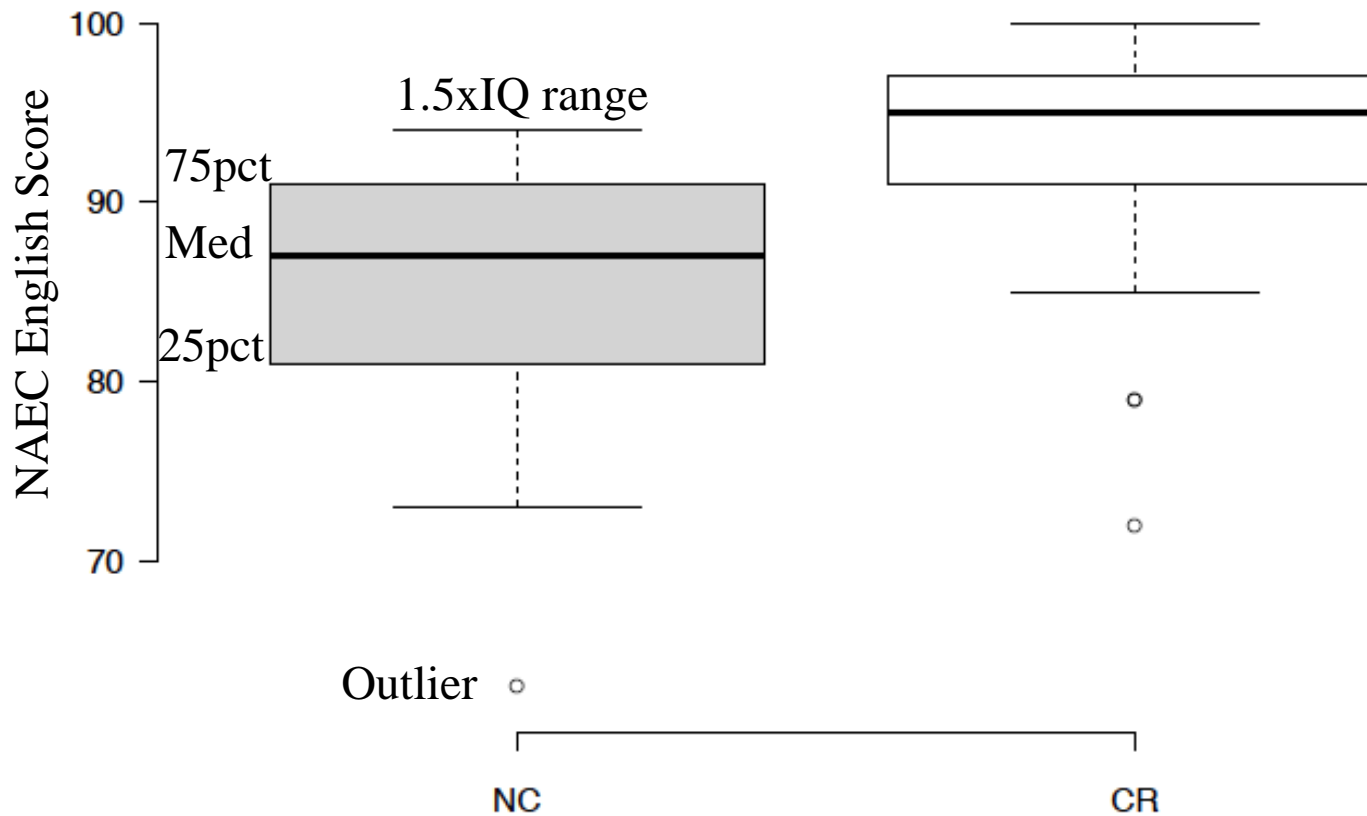



SAN DIEGO STATE
UNIVERSITY

Georgia

S

SCIENCE

T

TECHNOLOGY

E

ENGINEERING

M

MATH

NAEC math results for Math 141 students, by GROUPED final grade

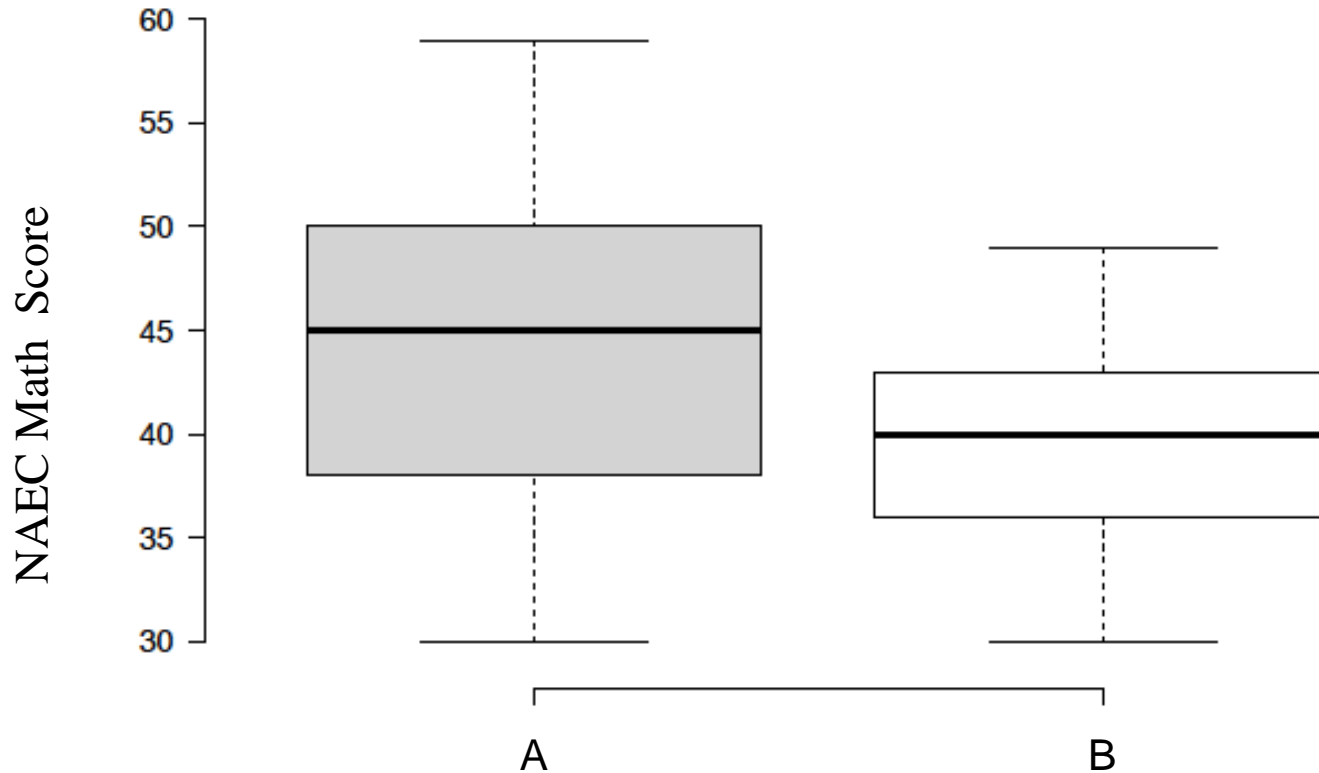



SAN DIEGO STATE
UNIVERSITY

Georgia



NAEC math results for Math 150 students, by GROUPED final grade

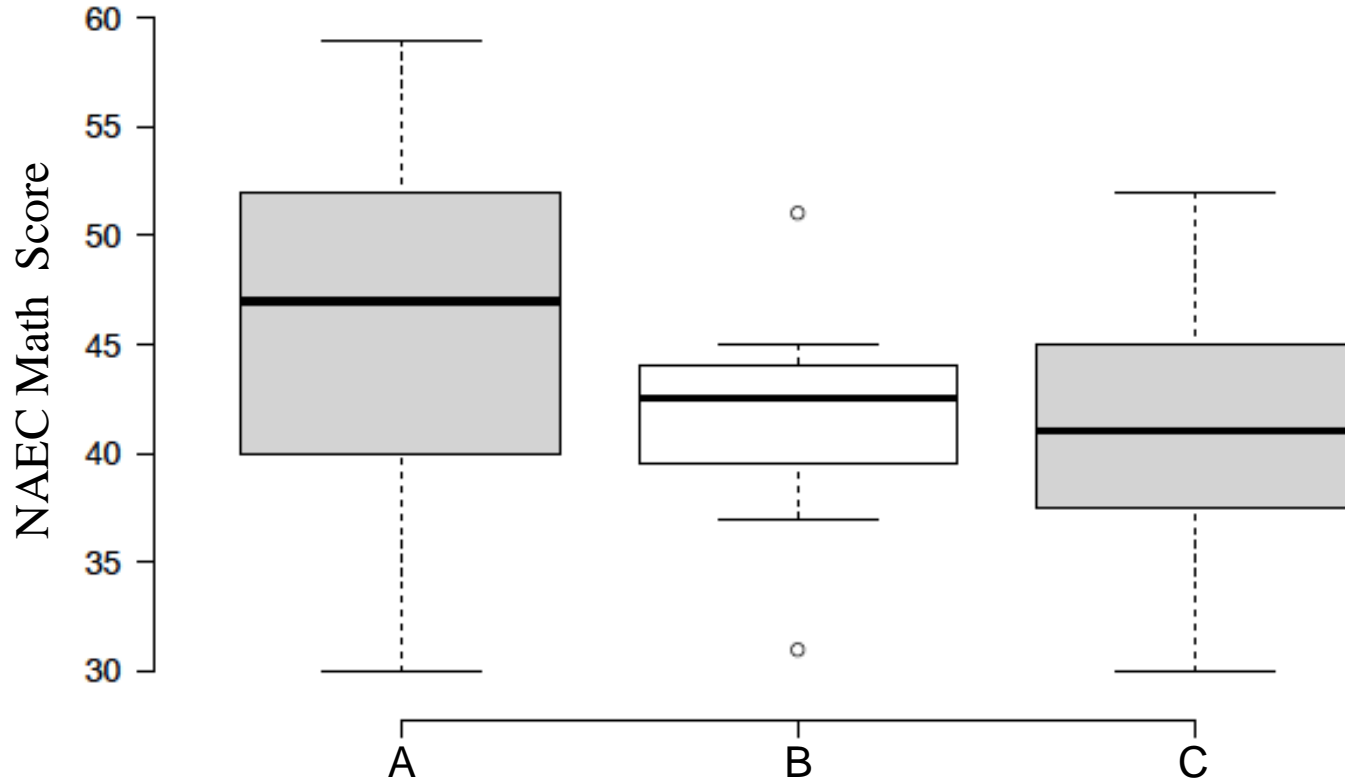



SAN DIEGO STATE
UNIVERSITY

Georgia



Math 150 Results Compared to Math 141 Results

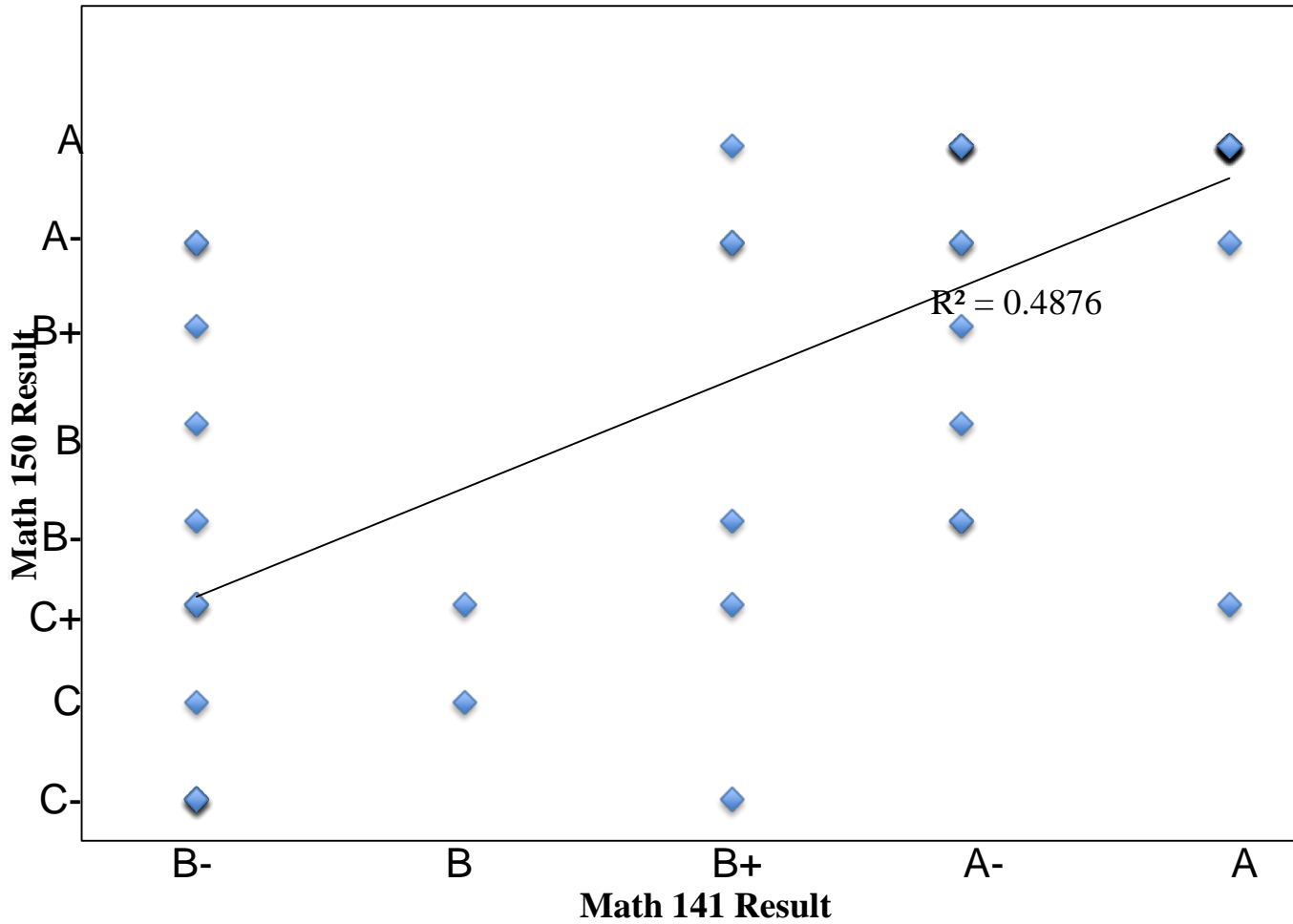



SAN DIEGO STATE
UNIVERSITY

Georgia

S

SCIENCE

T

TECHNOLOGY

E

ENGINEERING

M

MATH

Enrollment and Recruiting





SAN DIEGO STATE
UNIVERSITY

Georgia

S

SCIENCE

T

TECHNOLOGY

E

ENGINEERING

M

MATH

Spring Enrollment

- 84 Students enrolled
- 3 students on academic probation
- 3 international students –*GoG amendment on international students expected to help for future*



S

SCIENCE

T

TECHNOLOGY

E

ENGINEERING

M

MATH

Recruiting

- Target: Recruitment of minimum 150-200 fee-paying Georgian students.
- Recruitment of fee-paying international students
- Recruiting from socially vulnerable groups
- Increasing participation of women in STEM
- Increasing interest and participation of NGOs and industry in STEM education and STEM development in Georgia; securing scholarships



SAN DIEGO STATE
UNIVERSITY

Georgia

S

SCIENCE

T

TECHNOLOGY

E

ENGINEERING

M

MATH

SAN DIEGO STATE
UNIVERSITY
Georgia

SDSU Georgia

RECRUITMENT STRATEGY

FEEDER SCHOOLS

STEM BRANDING +++

EARLY RECRUITMENT



Outreach for Recruitment – Phases

2016

Phase I

February 5 – March 15

Call for Action – Apply SDSU

#ApplySDSU

Phase II

March 16 – May 1

- Retain the students who signed up through Apply SDSU
- Attract more students: Apply now and NAEC

#ApplyNow



SAN DIEGO STATE
UNIVERSITY

Georgia



NAEC registration results -- registration closed on March 15, 2016.
Students can change their preferences till end of July-

2016-2017

Uni	Code #	Program Name	Available spots	I	II	III	I-III	IV	V	VI	VII	VIII	IX	X	XI	XII	XIII	XIV	XV	XVI	XVII	XVIII	XIX	XX	All
TSU	0010111	1) Electric Engineering 2) Comp. Engineering.	100	31	16	14	61	7	7	4	2	6	7	2	0	2	2	1	1	1	0	0	0	1	104
	0010112	Comp. Science	50	19	13	9	41	10	5	7	2	2	2	4	3	1	0	1	0	2	1	0	1	1	83
	0010113	Chemistry/Biochemistry	50	24	8	2	34	4	3	3	1	3	1	2	1	1	1	1	0	1	0	0	0	2	58
GTU	0031101	1) Electric Engineering 2) Comp. Engineering.	40	0	4	4	8	3	3	6	1	0	0	0	0	0	0	1	1	0	0	1	0	0	24
	0031102	Comp. Engineering.	40	3	1	11	15	2	2	0	3	2	1	2	0	0	0	2	0	0	1	1	0	0	31
	0031103	Chemistry/Biochemistry	20	0	14	2	16	2	0	0	1	2	1	1	0	0	0	0	0	0	1	0	0	0	24
ISU	0100405	1) Electric Engineering 2) Comp. Engineering.	100	9	17	5	31	3	4	2	2	4	2	3	4	3	1	0	1	0	1	0	3	0	64
			400	86	73	47	206	31	24	22	12	19	14	14	8	7	4	6	3	4	4	2	4	4	357



SAN DIEGO STATE
UNIVERSITY

Georgia

S

SCIENCE

T

TECHNOLOGY

E

ENGINEERING

M

MATH

GENDER (FROM 121)

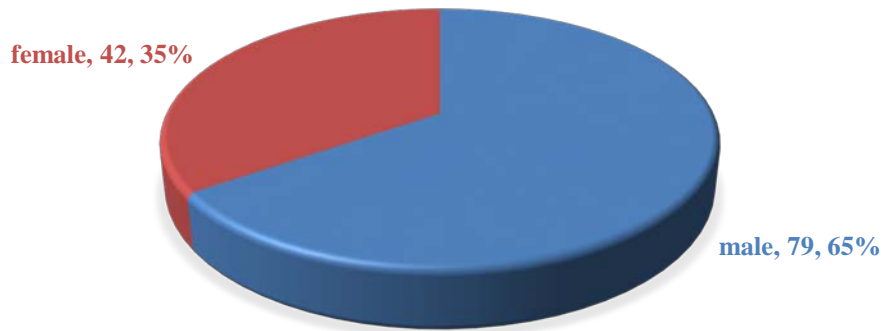

PROGRAMS

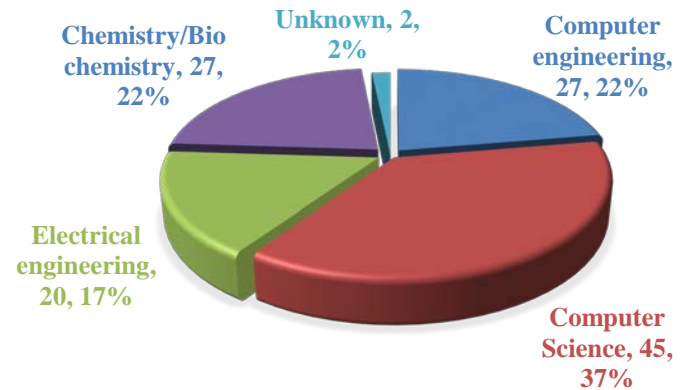



SAN DIEGO STATE
UNIVERSITY

Georgia



Applications	
From Tbilisi	72
Regions	49

TOTAL 121 STUDENTS

■ Tbilisi ■ Region

NEED-BASED/MERIT-BASED	
TOTAL	37
Tbilisi	12
Region	25

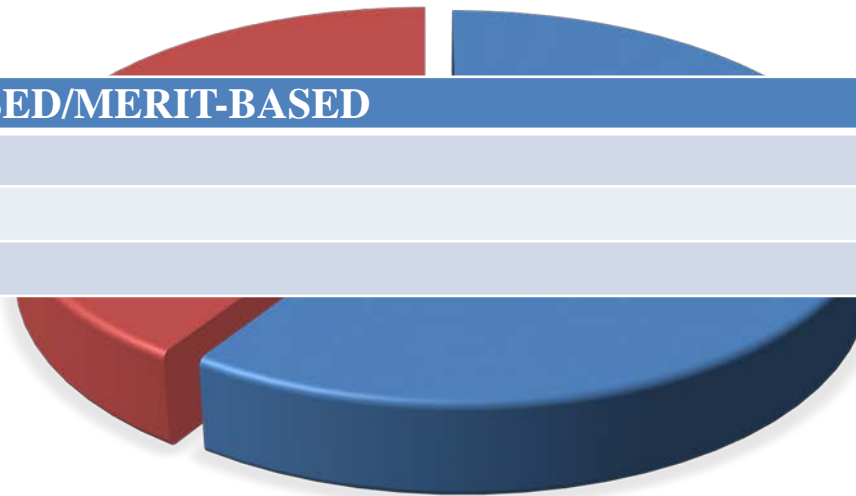

Tbilisi, 72, 59%

Events and Media Coverage – Phase 1

- ApplySDSU – Press Conference
- Google HashCode
- Minister of Education visit to chemistry lab
- **Imedi TV** - Generation that chooses STEM
- **Maestro TV** - SDSU G faculty study visit to SDSU
- **Rustavi 2** - Girls in STEM - SDSU students presented their projects on March 8
- **Forbes** - Importance of STEM education (Dean Walsh)
- **City Magazine** - SDSU G students as **It girl** and **It boy**



Activities – Phase II

- **Video Ad** on MyVideo.ge - 2 000 000 views until May 1st.
- **Online banner** – Naec.ge
- **Naec sms** – to all students who selected STEM
- **Special videos**: Student testimonials in Eng. and Geo distributed through Facebook, website
- **Facebook** – advertising of all SDSUG activities, videos, media coverage samples etc.
- **Newsletter** – distributed to all stakeholders
- **Media Coverage** – Rustavi 2 morning show, Temo Chichua on Tabula TV Mdzime Kactan, Georgia Today Business, OK Magazine.





SAN DIEGO STATE
UNIVERSITY

Georgia

S

SCIENCE

T

TECHNOLOGY

E

ENGINEERING

M

MATH

Capacity Building





Accreditation:

- WASC: Regional accreditation
 - Substantive Change proposal previously approved
 - Check visit confirmed for April 25-26
- ABET Processes
 - Successful visits for SDSU programs during Fall 2015
 - Formal results Summer 2016
 - Partner Universities:
 - GTU:
 - ABET Committee in place
 - Material collection starting
 - Draft self study Summer 2016
 - Upcoming conference with overall faculty
 - TSU and ISU are not as far along



SAN DIEGO STATE
UNIVERSITY

Georgia

S

SCIENCE

T

TECHNOLOGY

E

ENGINEERING

M

MATH

Faculty visits

- Two cohorts during Spring '16
- Total faculty visitors: 43





SAN DIEGO STATE
UNIVERSITY

Georgia

S

SCIENCE

T

TECHNOLOGY

E

ENGINEERING

M

MATH

First phase renovation

- 2200 m²
- Smart Classrooms
- Office and Storage
- Chemistry Laboratories



SAN DIEGO STATE
UNIVERSITY

Georgia

S

SCIENCE

T

TECHNOLOGY

E

ENGINEERING

M

MATH





SAN DIEGO STATE
UNIVERSITY

Georgia

S

SCIENCE

T

TECHNOLOGY

E

ENGINEERING

M

MATH





SAN DIEGO STATE
UNIVERSITY

Georgia

S

SCIENCE

T

TECHNOLOGY

E

ENGINEERING

M

MATH

Upcoming renovation

- 2300 m²
- Chemistry Laboratories
- Electrical and Computer Engrg Labs
- Smart Classrooms
- Library/Lounge Space
- Office



SAN DIEGO STATE
UNIVERSITY

Georgia

S

SCIENCE

T

TECHNOLOGY

E

ENGINEERING

M

MATH

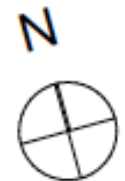
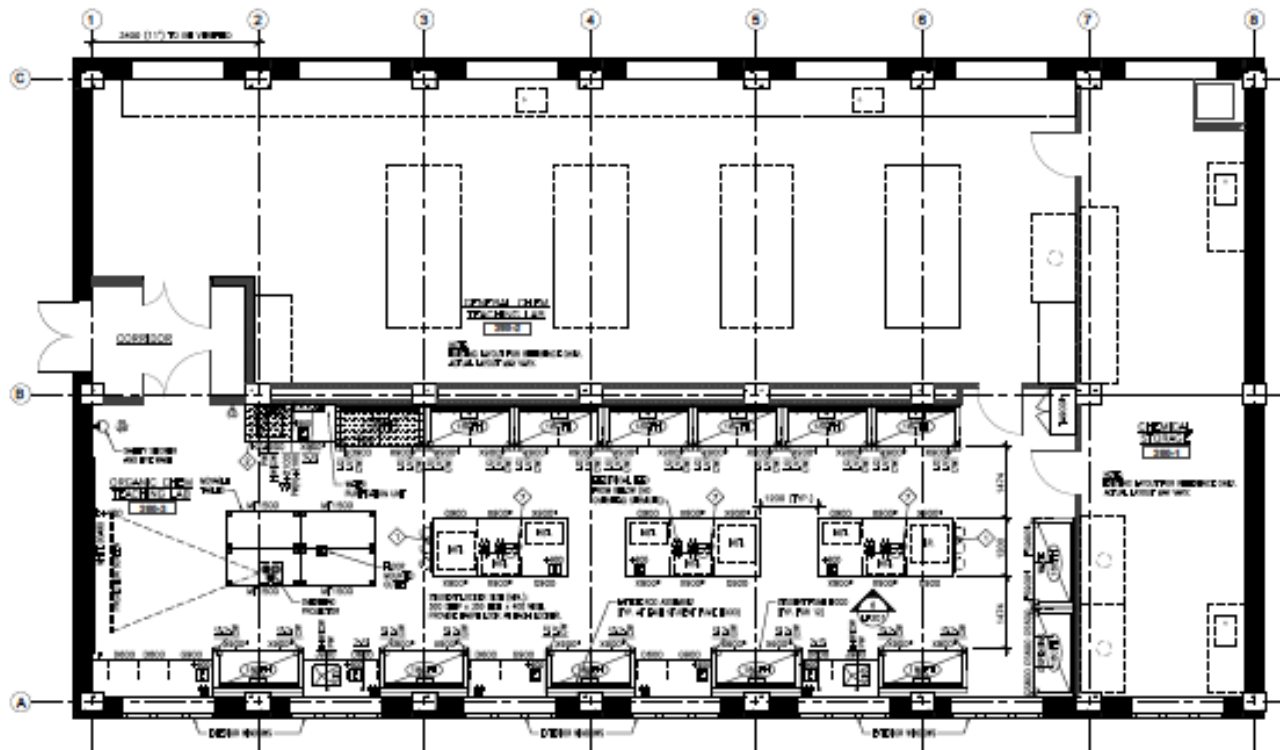



SAN DIEGO STATE
UNIVERSITY

Georgia

S

SCIENCE

T

TECHNOLOGY

E

ENGINEERING

M

MATH

Ilia State University

- 2200 m²
- Electrical and Computer Engrg Labs
- Civil and Construction Engrg Labs
- Smart Classrooms
- Library/Lounge Space
- Office

