

August 12, 2021

Iowa Dept Of Natural Resources
502 East 9th Street
Des Moines, Iowa 50319-5005
IA-HD-301-0266.000

RECEIVED

AUG 13 2021

Dear Landowner:

This letter is to notify you that Summit Carbon Solutions is proposing to build a new carbon capture and storage project in Hardin County, Iowa. The proposed project, Midwest Carbon Express, will capture carbon dioxide (CO₂) emissions that otherwise would be emitted into the atmosphere from ethanol plants, including Pine Lake Corn Processors LLC in Steamboat Rock, compress the captured emissions, and transport it through a pipeline to North Dakota where it will be permanently and safely stored underground in deep geologic storage locations. In addition to Hardin County, the proposed project will be located in 29 other Iowa counties plus communities in Minnesota, Nebraska, South Dakota and North Dakota and will be capable of capturing and safely storing up to 12 million tons of CO₂ emissions every year.

A public informational meeting regarding Summit Carbon Solutions' proposed carbon capture and storage project will be held by the Iowa Utilities Board. At the meeting, additional details of the proposed project and information regarding the legal rights of affected landowners will be presented. Time will also be given to address questions from attendees. The meeting is expected to last approximately one hour. Specific details of the public informational meeting are as follows:

- When: September 13, 2021 at 12:00 pm
- Where: Timbers Edge at 19493 Co Hwy S56, Steamboat Rock, IA 50672
- Light refreshments will be provided

Your receipt of this letter indicates that right of way on or near property in which you have a legal interest could potentially be affected by the construction of the project. Summit Carbon Solutions will be seeking permanent easements for its pipeline on or near your property, as well as easements for temporary construction workspace, as well as access easements. Enclosed is a map showing the proposed route and the notification corridor in which potentially affected properties are located. The final alignment of the pipeline within the identified corridor will be selected after negotiations with landowners are complete. Please join the informational meeting for additional details regarding the purpose, timing and routing of the proposed project. You have the right to be present at this informational meeting and to file objections with the Iowa Utilities Board if you so choose. Under Iowa law, Summit Carbon Solutions cannot negotiate with landowners in Hardin County before the public informational meeting on September 13, 2021.

If you are unable to attend this informational meeting, you may also attend one of the other meetings scheduled to take place in September and October. A full list of meetings is provided in this letter as well. Persons with disabilities requiring assistive services or devices to observe or participate should contact the Iowa Utilities Board at (515) 725-7300 in advance of the scheduled date to request that appropriate arrangements be made. Additionally, the Iowa Utilities Board will host a virtual meeting allowing individuals to attend and participate remotely. The virtual meeting will take place at 5:30 pm on October 12, 2021. Information for registering and attending the webinar will be available on the Iowa Utilities Board website, iub.iowa.gov, on the Hearing and Meeting Calendar webpage. If you would like to learn more about Summit Carbon Solutions' proposed carbon capture and storage project, please visit our website at www.SummitCarbonSolutions.com or email us at InfolA@summitcarbon.com. Even if you cannot attend one of the informational meetings or are unable to contact us through our website, a member of our land team will be in contact with you over the coming months to explain the project and the upcoming steps in the development process.

Finally, if you have any tenants or other persons in possession on your property, please share this information with them. If you would let us know about any tenants and their contact information as well, we would appreciate your assistance.

Thank you for your time and we look forward to speaking with you.

Sincerely,

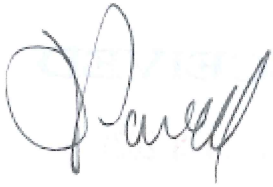
A handwritten signature in black ink, appearing to read "Jimmy Powell". The signature is fluid and cursive, with the first name "Jimmy" being larger and more prominent than the last name "Powell".

Jimmy Powell
Chief Operating Officer
Summit Carbon Solutions
Principle Place of Business:
1805 Collaboration Place Suite 1200
Ames, IA 50010

Enclosures:

Listing of All Informational Meetings
Project Overview Map
County Specific Map
Statement of Damage Claims

SUMMIT CARBON SOLUTIONS
POLICY STATEMENT CONCERNING SETTLEMENT OF DAMAGE CLAIMS

During construction of a carbon dioxide (CO₂) pipeline, damage is sometimes caused to a landowner's and/or tenant's property. If Summit Carbon Solutions causes physical damage to property, the landowner and/or tenant, as their respective interests appear, (Landowner/Tenant) will be compensated by Summit Carbon Solutions in the following manner. The following damage payments would be in addition to and separate from any payments made to the landowners for temporary and permanent easements. Payments for any temporary or permanent easements will be made to the landowners prior to any construction activities.

I. Crop Loss Due to Pipeline Construction

- A) If a crop has been planted prior to construction of the CO₂ pipeline or if a crop normally would have been planted before the finish of construction, Summit Carbon Solutions will pay the following percentages of the crop lost to production (the following compensation table will be based upon the prevailing market price index by crop type or in accordance with any prearranged purchase agreements and based upon the three-year annual average of the crop yield as documented by the landowner or by the records from the local agricultural agency):

Full disturbed area, including permanent and temporary easements as well as additional temporary workspace and other areas as agreed to between the company and the landowner:

- First Year: 100% of crop loss
- Second Year: 80% of crop loss
- Third Year: 60% of crop loss

II. Damages Due to Compaction, Ruts, and/or Erosion

- A) Summit Carbon Solutions and/or the construction contractor will repair damage incurred due to compaction, ruts, washing of soil, and/or erosion caused by pipeline construction. Alternatively, Landowner may request to use their own contractor and Summit Carbon Solutions and/or the construction contractor will, based on an estimate from that contractor, provide payment for such repairs if the estimate is determined to be reasonable. Payment will be made by Summit Carbon Solutions and/or the construction contractor within 30 days upon presentation of a statement or invoice of services, repairs, or claims.

B) Summit Carbon Solutions and/or the construction contractor will pay for the reasonable cost of repairs to the Landowner's/Tenant's equipment where in repairing compaction, ruts, washing of soil, and/or any resultant damage to equipment that was caused by materials or debris left on the right of way during construction.

III. Other Damages

Summit Carbon Solutions and/or the construction contractor will repair or pay for all damages to pastures, timber, fences, improvements, livestock, terraces, field tiles, and equipment caused by Summit Carbon Solutions and/or the construction contractor's entry, use or occupation of lands, both on and off an easement area, due to the CO2 pipeline construction. Alternatively, Landowner may request to use their own contractor and Summit Carbon Solutions and/or the construction contractor will, based on an estimate from that contractor, provide payment for such repairs if the estimate is determined to be reasonable. Certain livestock related losses are also compensable losses, as determined by Iowa Code 479B.29, and will be paid by Summit Carbon Solutions and/or the construction contractor within 30 days of presentation of a statement or invoice of any loss of livestock resulting from the construction of the proposed pipeline.

IV. Manner of Damage Payments

Payment of crop damages to the Landowner/Tenant will be made by Summit Carbon Solutions and/or the construction contractor in one lump sum payment and not as an annual payment and will be payable within 30 days following completion of pipeline construction. Prepayments of predetermined damages may be made based upon landowner agreements and/or preferences during the easement negotiations. In such cases, any future payments will only be for unanticipated damages outside the predetermined amount and as agreed upon between the company and landowner.

V. Dispute Resolution Procedure

If the parties cannot agree on a settlement and no other means of resolving disputes has been agreed to, the landowner or tenant may petition the county board of supervisors to have the damages determined by a Compensation Commission (Iowa Code Chapter 6B and Iowa Code section 479B.30). The petition must be filed not less than 90 days after completion of installation of the pipeline. This Compensation Commission would be similar to, but acting separately from, a commission established for condemnation proceedings under Iowa Code Chapter 6B.

(This policy statement is filed with the Iowa Utilities Board pursuant to Iowa Administrative Code 199-Chapter 13.2(3)).

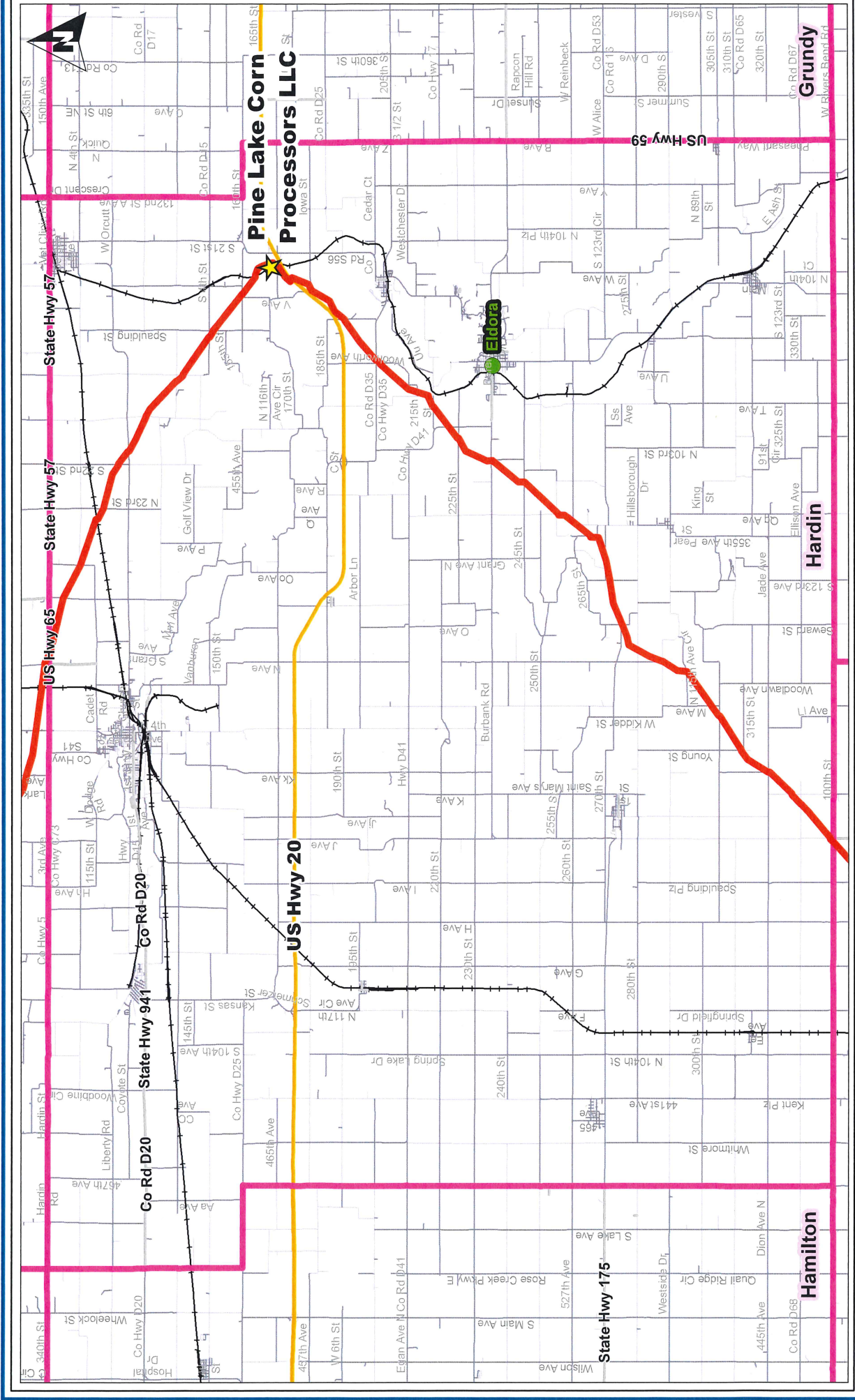

SUMMIT CARBON SOLUTIONS

DWG: SC520022 SHEET: 1

Hardin County Iowa
Pipeline Mileage Overview

COUNTY: HARDIN	DRAWN BY: PVD
STATE: IOWA	CHECKED BY: PVS
REV. NO.: 0	REVISION
DATE	DATE
ISSUED FOR REVIEW	2017-05-04

**PRELIMINARY ROUTE
SUBJECT TO CHANGE**

DATE: 05/02/17 PROJECTION: GCS NAD83

34.42 MILES OF ANTICIPATED PIPELINE IN HARDIN COUNTY IOWA

LEGEND

- Participating Ethanol Plant (Yellow Star)
- County Seat City (Green Circle)
- Route (Red Line)
- Primary Road (Yellow Line)
- Secondary Road (Grey Line)
- Local Road (Thin Grey Line)
- Railroad (Black Line with Cross-ticks)
- Highly Populated Area (Yellow Shaded Area)
- County Boundary (Pink Line)
- State Boundary (Black Line)

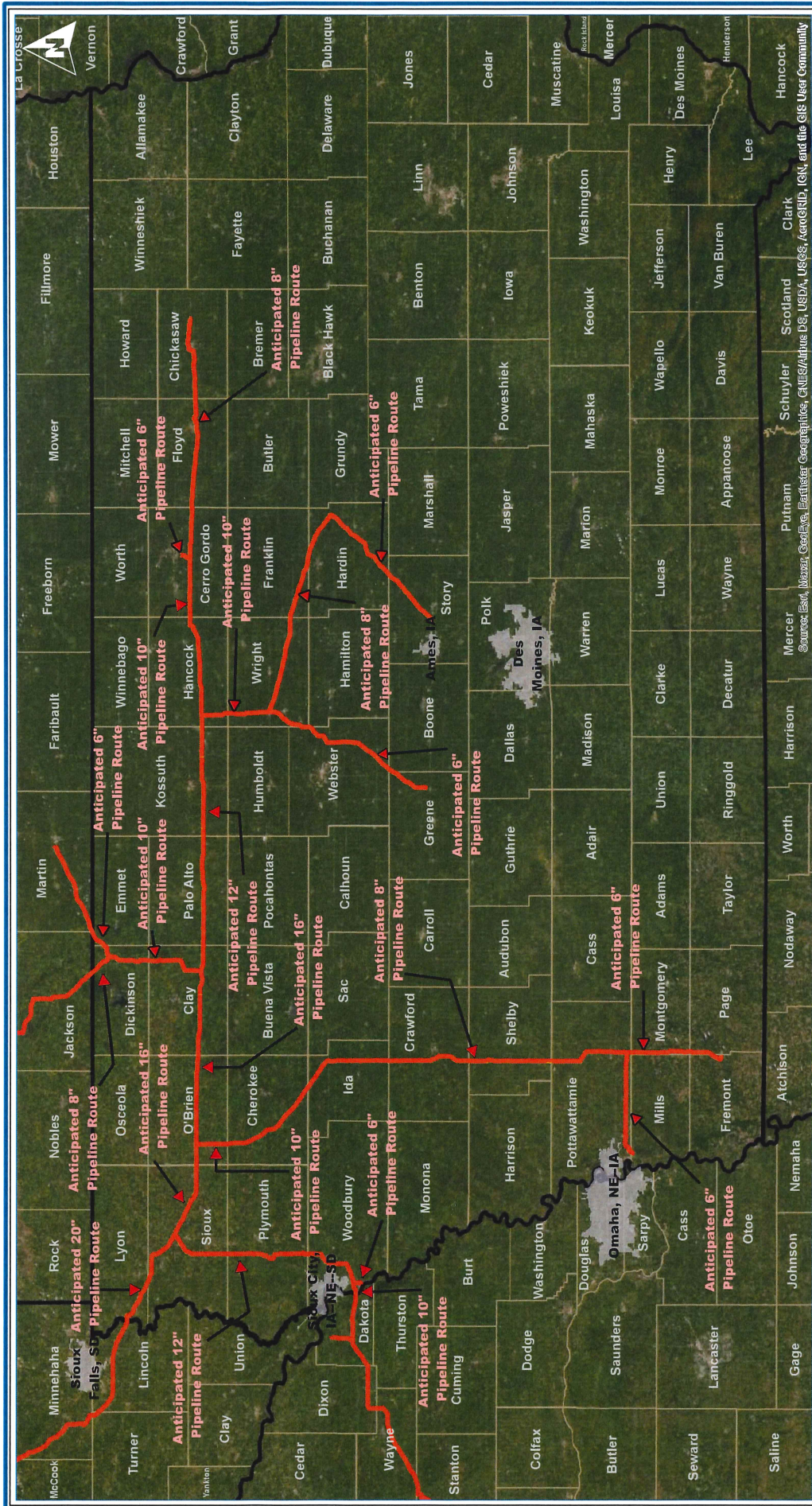

706.42 MILES OF ANTICIPATED PIPELINE ROUTES IN IOWA

LEGEND

- State Boundary
- County Boundary
- Highly Populated Area
- Route

Iowa Pipeline Mileage Overview

COUNTY:	MULTIPLE	DRAWN BY:	PNVP
STATE:	IOWA	CHECKED BY:	PNVS
REV. NO.:	1	REVISION	DATE
		07/20/2021	ISSUED ROUTING
			2013-07-26

CONFIDENTIAL & PRELIMINARY

DATE: 7/20/2021 PROJECTOR: UCS MUEB DWG: SCS-03-004 SHEET: 1

SUMMIT CARBON SOLUTIONS

Source: Esri, DeLorme, GeoEye, Earthstar Geographics, CNES/Airbus DS, USDA, USGS, AeroGRID, IGN, and the GIS User Community

Scale: 0 15 30 60 Miles

706.42 MILES OF ANTICIPATED PIPELINE ROUTES IN IOWA

PIPELINE ROUTES IN IOWA

